











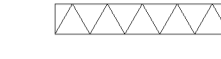
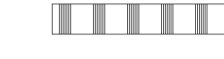
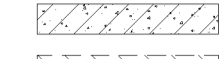
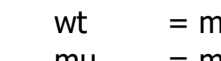
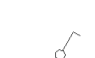



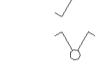



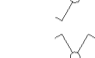

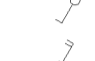
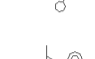
Renveroo Algemeen

	= gevelsteen		= kalkzandsteen		= separatiewand zwaar
	= isolatie		= separatiewand		= beton prefab
	= onbenoemde ruimte als gevolg van krijstreepmethode				

wt	= mogelijke plaats wasautomaat	sr	= standleiding riool
mu	= mechanische ventilatieunit	rm	= rookmelder
vr	= ventilatie rooster	pv	= zonnepaneel
la	= ventiel luchtafvoer (indicatief)	ov	= omvormer zonnepanelen
mk	= meterkast (met groepen en opstelling stadsverwarming)	r.	= radiator (positie en afmeting indicatief)
vi	= vloerluis		
vd	= verdeler vloerverwarming		
k.in	= plaats keukeninrichting		
kk	= mogelijke plaats koelkast		

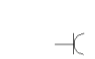
Renveroo Elektra

	= enkelpolige schakelaar		= lichtpunt plafond (bewegingmelder)
	= wisselschakelaar		= lichtpunt wand (bewegingmelder)
	= serieschakelaar (enkelpolig)		= loze leiding boiler/vaatwasser
	= serieschakelaar (wissel)		= loze leiding
	= serieschakelaar (enkelpolig / wissel)		= cv thermostaat
	= schakelaar pv panelen		= signaalgong
	= CO2 sturing mechanische ventilatie		= beldrukker
	= wandcontactdoos t.b.v. elektrisch koken		= rookmelder
	= wandcontactdoos		
	= wandcontactdoos vloerverwarming unit		
	= wandcontactdoos stadsverwarming		
	= dubbele wandcontactdoos (opbouw)		
	= dubbele wandcontactdoos (inbouw)		
	= wandcontactdoos t.b.v. eventuele afzuigkap		

De optionele indelingen zijn afgebeeld in de tekening van bouwnummer 526.
De gevels en gevelkozijnen kunnen hierdoor afwijken t.o.v. uw woning. Dit geldt ook voor de gespiegelde woningen.

*positie mv ventielen indicatief
*positie en afmeting radiatoren indicatief

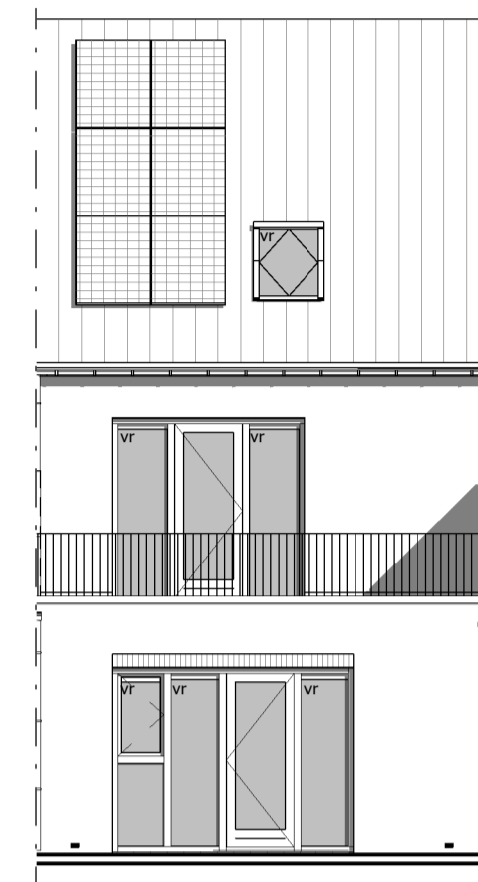

Achtergevel
standaard achtergevel

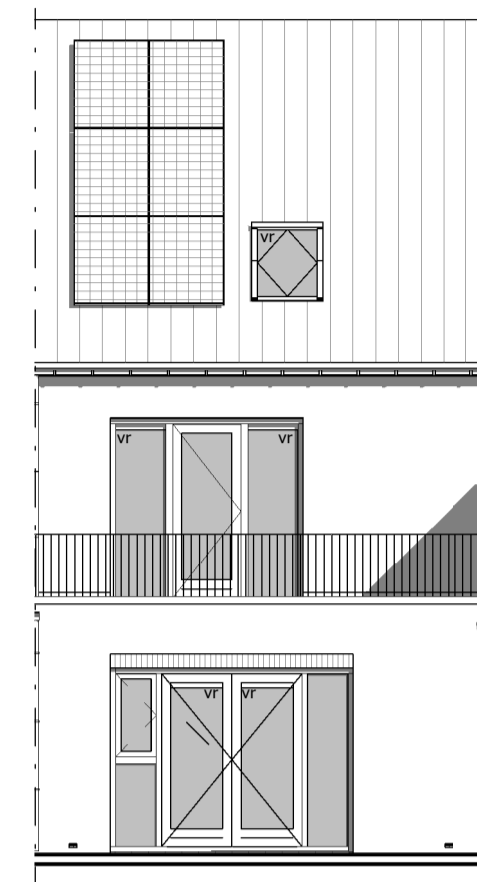

Achtergevel
optie openslaande deuren

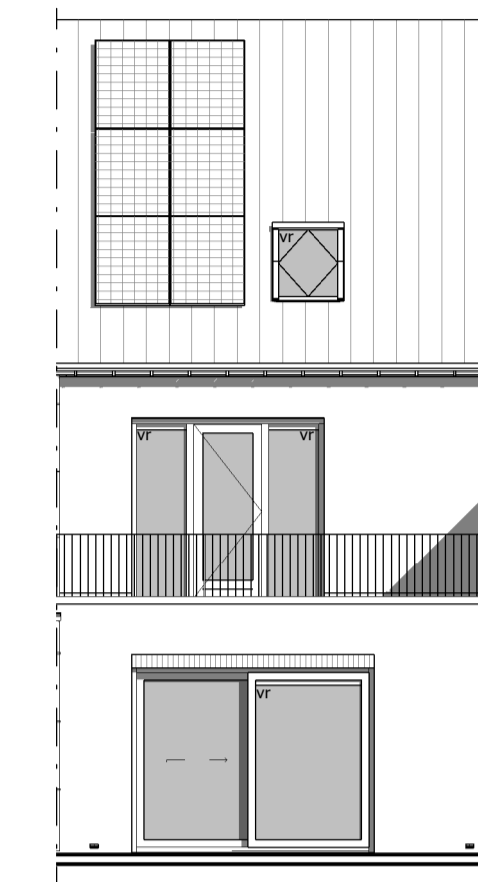

Achtergevel
optie schuifpui

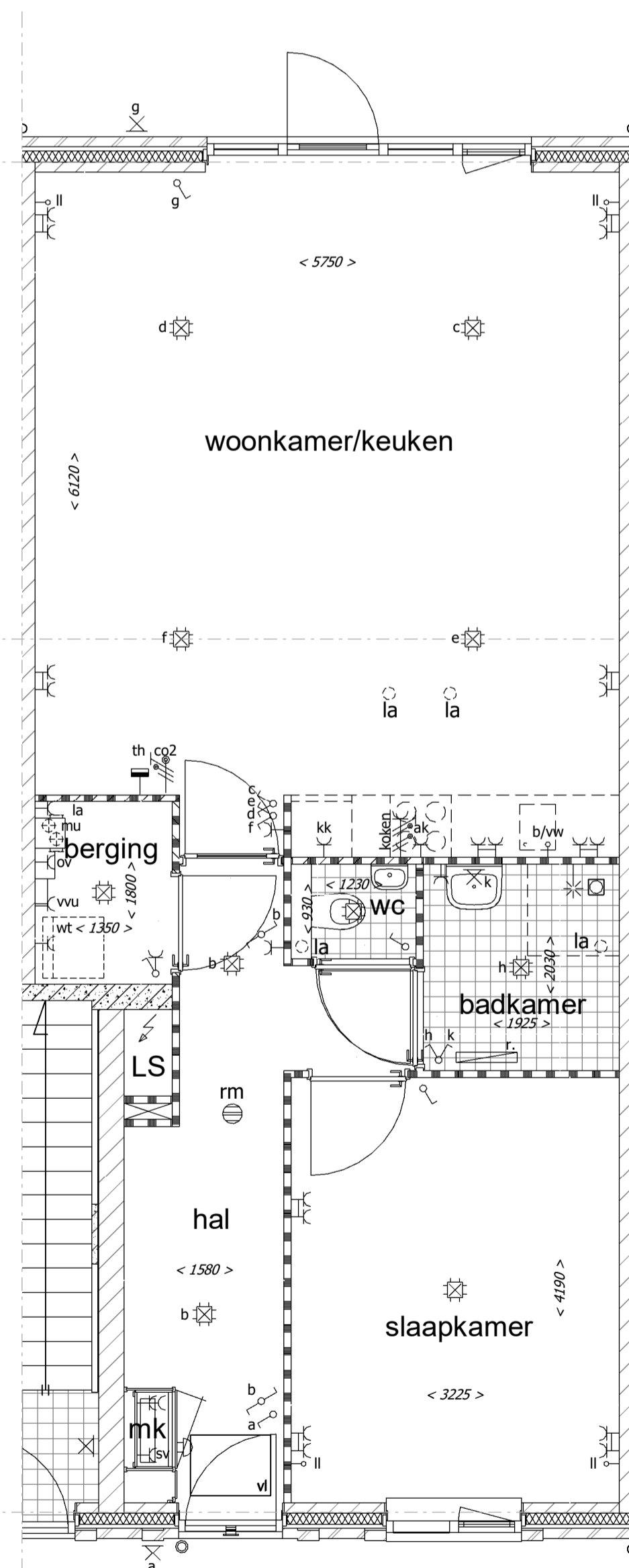

Standaard indeling

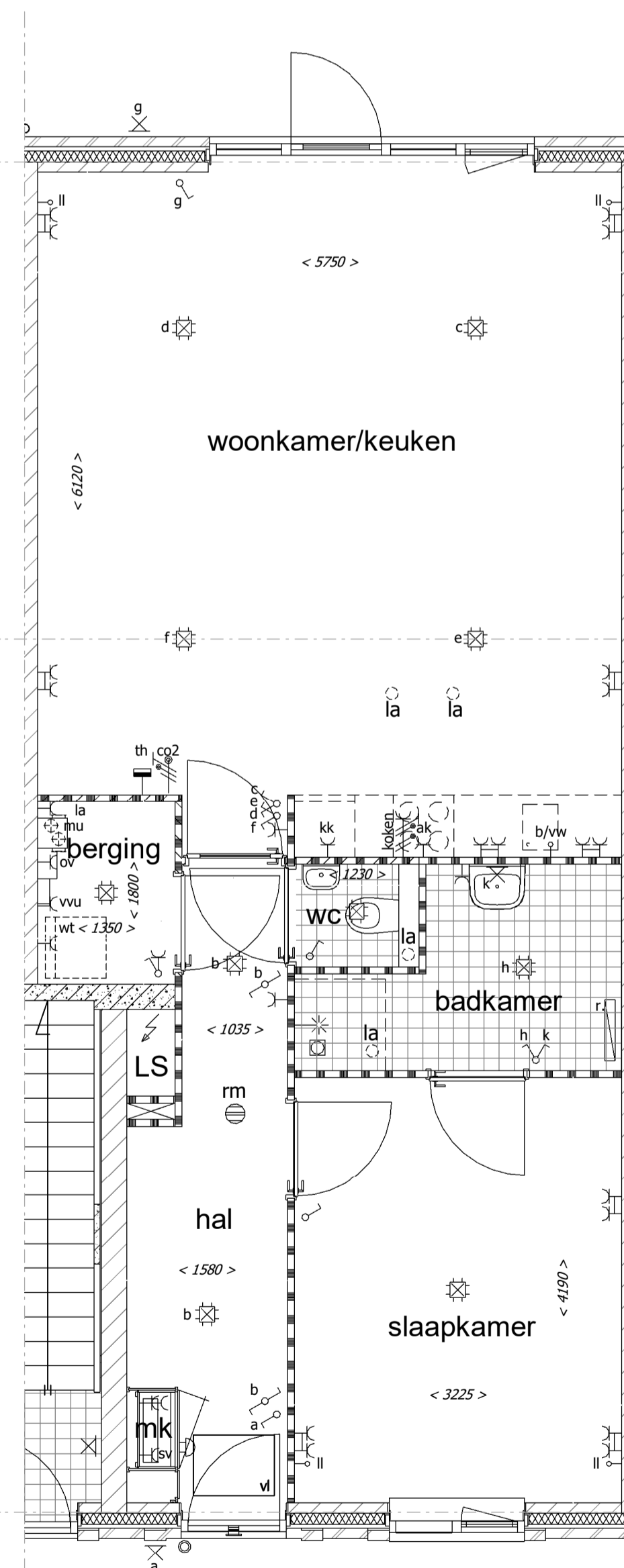

Optie waarbij de badkamer
toegankelijk is vanuit de slaapkamer

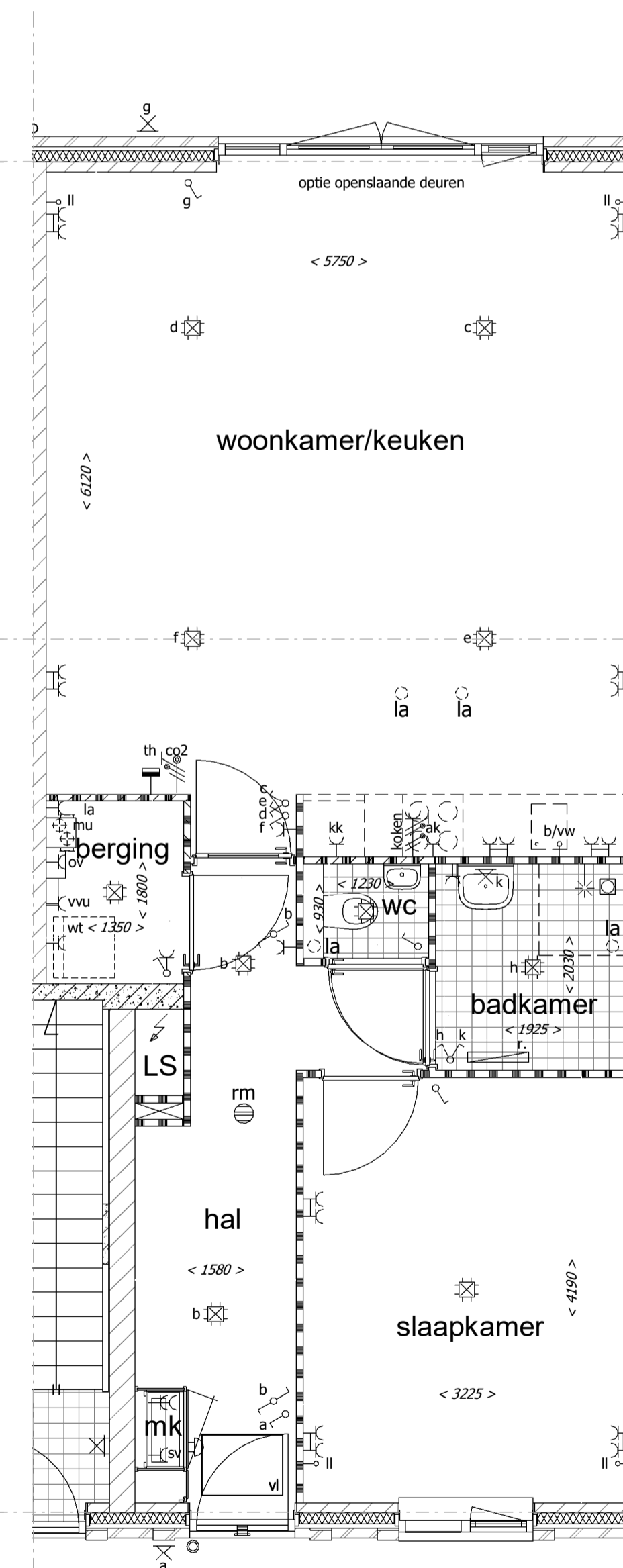

Optie openslaande deuren

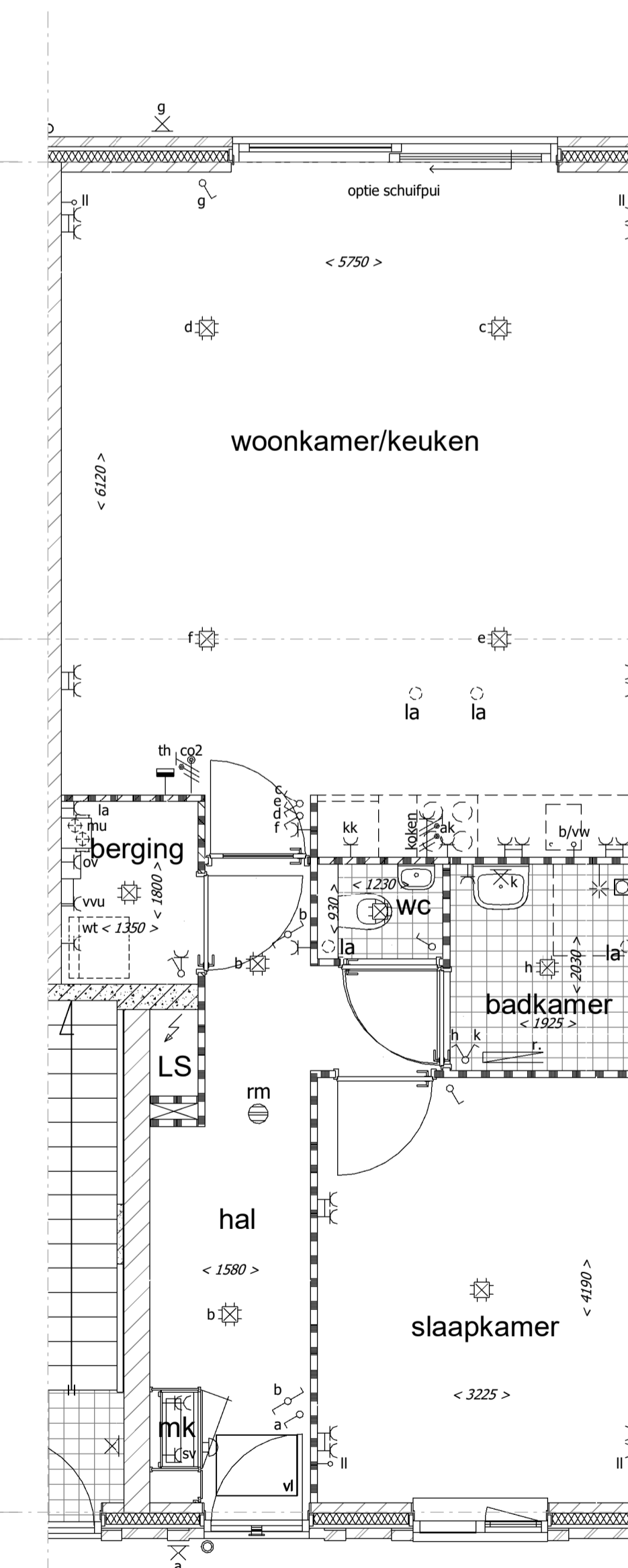

Optie schuifpui

Uitvoering:



Morseweg 1
T +31299 - 367322

1131 PE Volendam
E info@kbkbouwgroep.nl

Technische uitwerking:



Julianaweg 141, 1131 DH Volendam
+31299-363468, info@tbe-za.nl

Getekend	Datum	Project	69 WONINGEN TE MIDDENBEEEMSTER plan "DE KEIZER" fase 5
DK	06-09-2019	Onderdeel	OPTIE TEKENING begane grond en gevels Type C BEBO woningen
Schaal	1:50/100	Oprachtgever	KBK Bouw B.V. Morseweg 1, 1131 PE VOLENDAM
Formaat	841x594		